

Département de la SARTHE  
Commune de SAINT MARS D'OUTILLE  
*Lotissement "LE PLESSIS"*

Date: 12/02/2026

**PLAN DE LOT n°3**

Cadastre: Section B - n°1834

Surface d'arpentage: 840 m<sup>2</sup>

SHON: 300 m<sup>2</sup>

PLAN DE SITUATION - Sans échelle

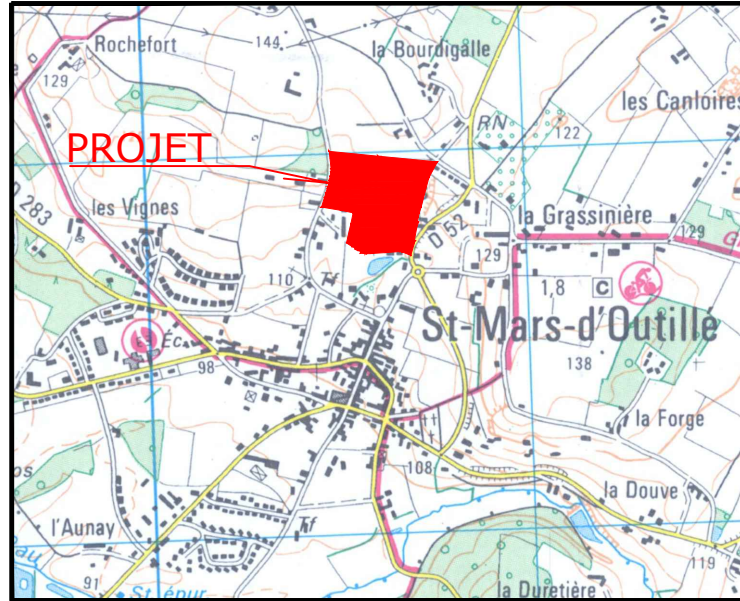

PLAN D'ENSEMBLE - Sans échelle

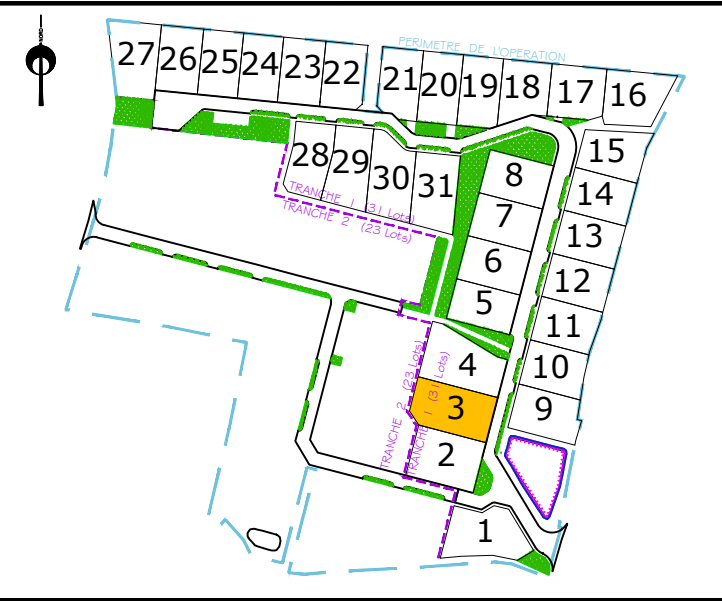

PLAN DE BORNAGE- Echelle: 1/500

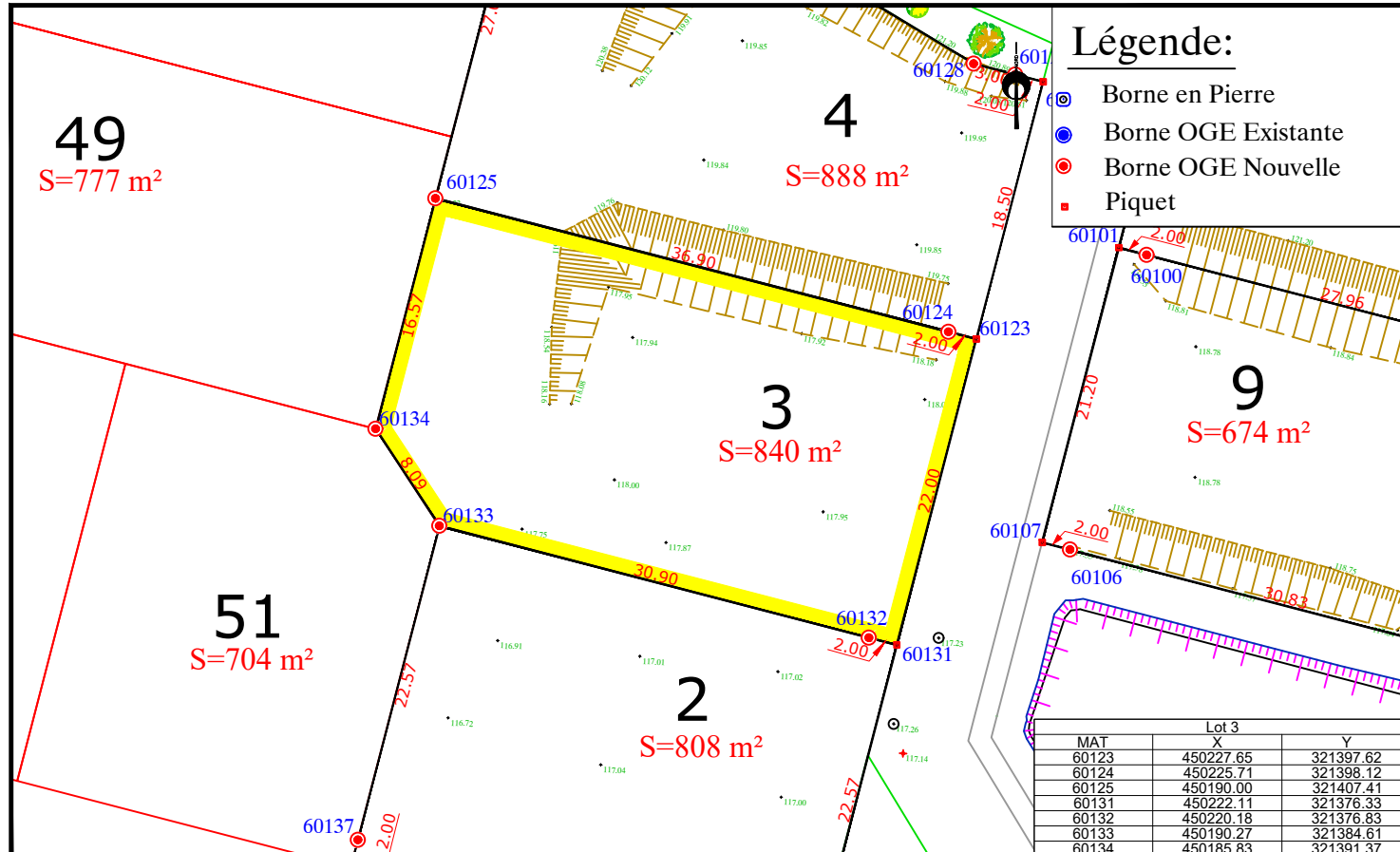

EXTRAIT DU PLAN DE COMPOSITION - Echelle: 1/500

Date: 09/11/11

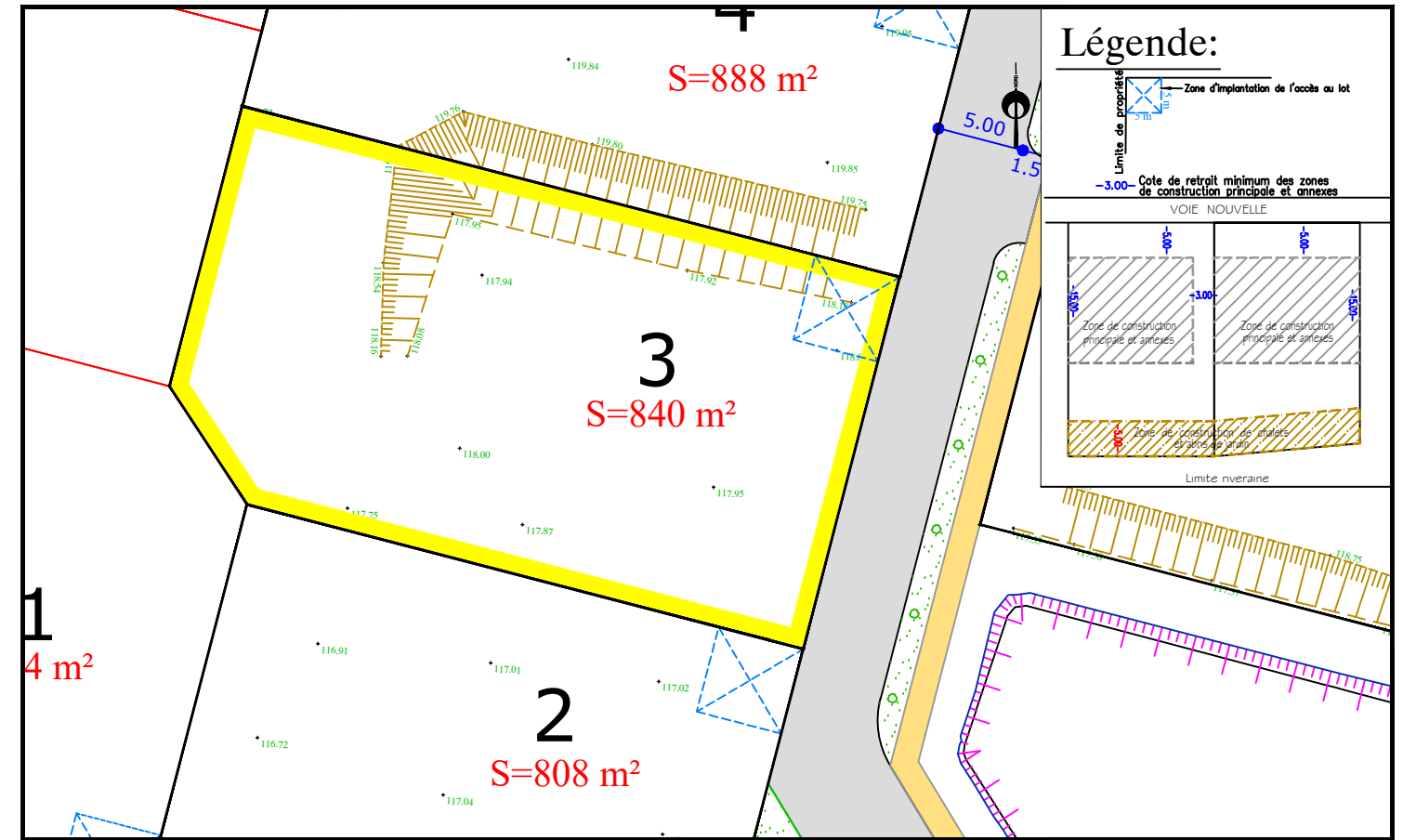

EXTRAIT DE PLANS VRD - Echelle: 1/500

