

Département de la SARTHE
Commune de SAINT MARS D'OUTILLE
Lotissement "LE PLESSIS"

Date: 12/02/2026

PLAN DE LOT n°2

Cadastre: Section B - n°1863 et 1867 Surface d'arpentage: 808 m² SHON: 300 m²

PLAN DE SITUATION - Sans échelle

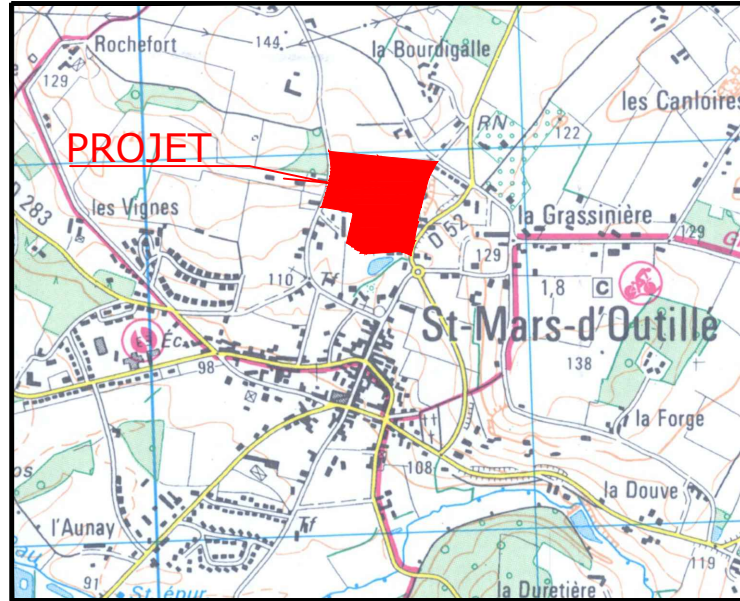

PLAN D'ENSEMBLE - Sans échelle

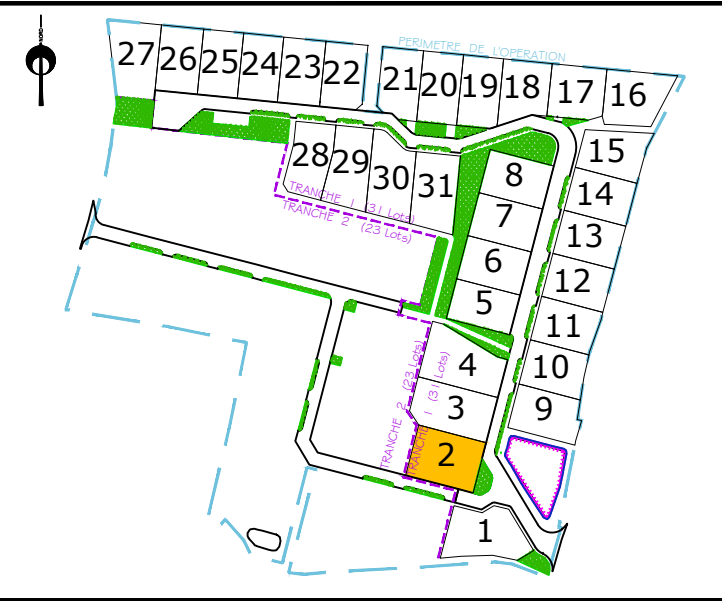

PLAN DE BORNAGE- Echelle: 1/500

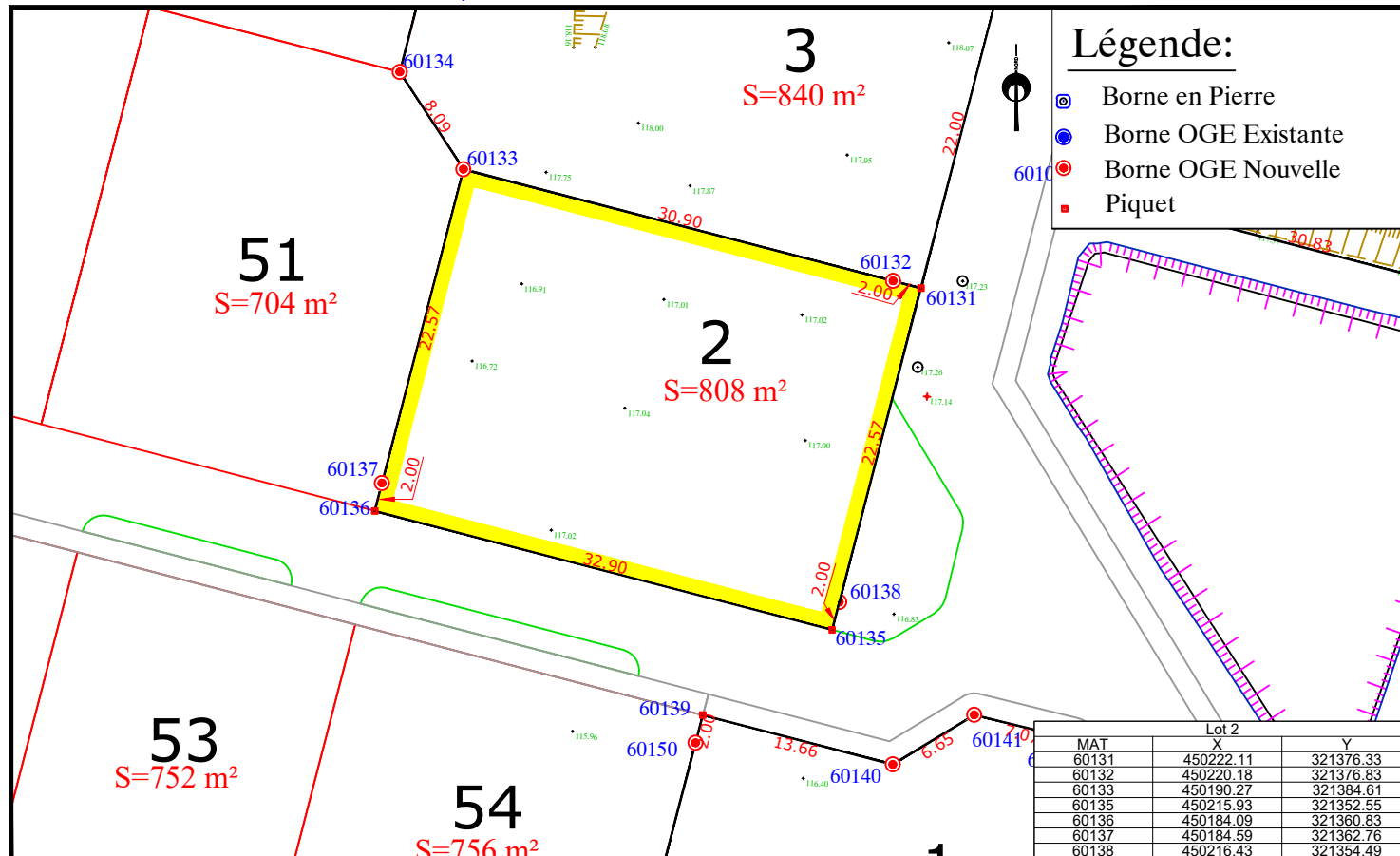

EXTRAIT DU PLAN DE COMPOSITION - Echelle: 1/500

Date: 09/11/11

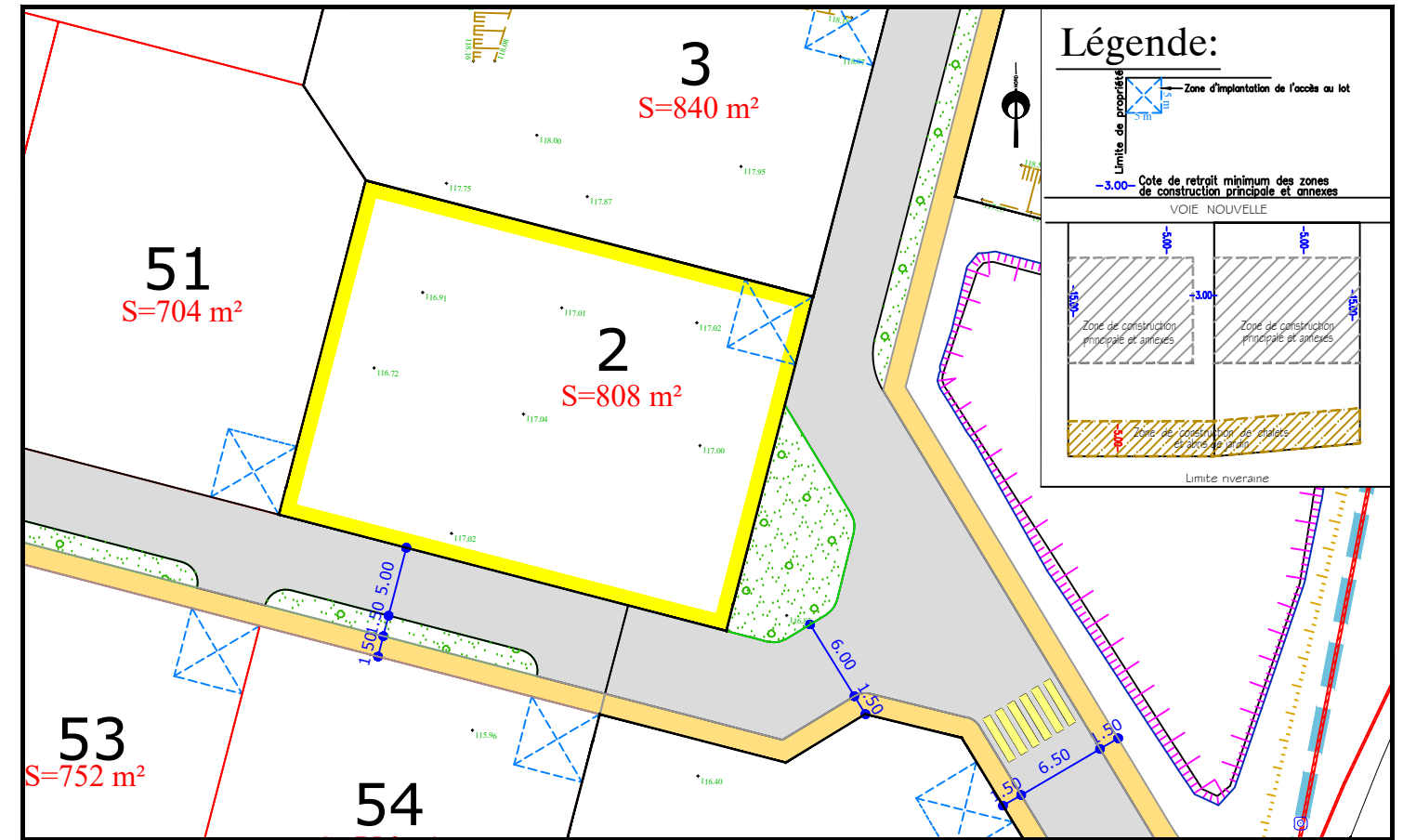

EXTRAIT DE PLANS VRD - Echelle: 1/500

